

HMM motor

HMM series motor is mini-motor with high speed, very compact design, spool valve, economical type motor.

Characteristic features:

- Compact design of spool and gear set, which provide mini volume, high power and low weight..
- Credible design for shaft seal , which can bear high pressure and be used in parallel or in series.
- Direction of shaft rotation and speed can be controlled easily and smoothly.



Main Specification

Type		8	12.5	20	32	40	50
Displacement (ml/r)		8.2	12.9	19.9	31.6	39.8	50.3
Flow (LPM)	Cont.	16	20	20	20	20	20
	Int..	20	25	25	25	25	25
Speed (RPM)	Cont.	1950	1550	1000	630	500	400
	Int..	2450	1940	1250	800	630	500
Pressure (MPa)	Cont.	10	10	10	10	9	7
	Int..	14	14	14	14	14	14
Torque (N*m)	Cont.	11	16	25	40	45	46
	Int..	15	23	35	57	70	88

Note: 1.Continuous data: The Max. Value of operating motor continuously.

2.Intermittent Data: The Max. Value of operating motor in 6 seconds per minute.

3.A simultaneous max. RPM and max. pressure is not recommended.

4.The Conversion Factors is on the page 4, consult it please

5.Optimum operating situation should be at the 1/3 ~ 2/3 of the continuous operating situation.

HMM Performance Data

□ cont.
■ Int.

HMM-8

		压力 ΔP (Mpa)					
		3.5	5	7	10	12	14
流量 Flow (LPM)	2	3 228	5 218	8 206	10 156	12 111	14 58
	4	3 474	5 471	7 463	11 426	13 391	15 331
	8	3 953	15 946	7 926	11 884	13 855	15 816
	12	2 1444	5 1426	7 1402	10 1360	13 1324	15 1288
	15		4 1912	7 1900	10 1861	12 1833	14 1780
	20			6 2395	10 2350	11 2328	14 2281

Torque 11 Nm
Speed 2328 rpm

HMM-12

		压力 ΔP (Mpa)					
		3.5	5	7	10	12	14
流量 Flow (LPM)	2	6 140	8 136	11 119	16 68	19 35	
	4	6 296	8 289	12 274	17 229	19 200	23 145
	8	5 605	8 596	12 583	17 543	20 514	24 469
	12	5 912	8 905	11 895	16 859	20 834	24 784
	15	5 1152	7 1144	11 1136	16 1102	19 1078	23 1036
	20	3 1542	7 1532	10 1521	15 1500	19 1482	22 1437
25	2 1910	6 1891	9 1878	14 1848	18 1828	22 1788	

HMM-20

		压力 ΔP (Mpa)						
		1.7	3.5	5	7	10	12	14
流量 Flow (LPM)	2	3 99	9 96	14 89	19 74	26 42	30 21	
	4	4 197	9 191	14 182	19 178	26 134	31 112	36 74
	8	4 398	9 395	13 391	19 377	27 340	31 319	36 288
	12	3 596	8 594	13 588	18 579	26 545	31 523	37 493
	15	3 745	8 741	12 738	17 728	25 695	30 684	36 660
	20	1 998	6 995	11 991	19 985	24 962	29 916	35 885
25		4 1247	9 1245	14 1242	23 1189	28 1180	33 1176	

HMM-32

		压力 ΔP (Mpa)						
		2	3.5	5	7	10	12	14
流量 Flow (LPM)	2	7 61	15 57	21 52	28 47	40 16		
	4	7 126	15 121	21 114	29 106	41 82	48 67	57 49
	8	7 250	15 244	21 239	29 231	41 207	49 194	58 167
	12	6 378	13 374	20 369	28 362	40 338	48 322	58 297
	15	4 476	12 472	18 468	27 462	39 441	47 429	57 406
	20	3 633	10 630	17 627	25 619	37 601	46 585	55 566
25	1 791	8 789	15 787	23 783	35 766	43 753	52 732	

HMM-40

		压力 ΔP (Mpa)					
		3	5	7	8.5	10	12
流量 Flow (LPM)	2	16 45	27 40	36 34	44 28	51 17	
	4	16 96	27 93	37 85	44 79	52 65	62 52
	8	15 197	26 195	36 182	44 176	52 166	62 154
	12	14 293	25 287	35 282	43 277	51 268	62 257
	15	13 371	24 365	34 360	42 355	50 347	62 338
	20	10 497	21 492	31 487	39 480	48 472	59 463
25	7 622	19 617	29 612	37 607	44 600	56 591	

HMM-50

		压力 ΔP (Mpa)				
		1.5	3	5	7	10
流量 Flow (LPM)	2	11 37	23 33	36 27	50 22	
	4	11 76	22 73	36 68	50 63	70 55
	8	11 157	21 154	35 149	50 145	71 137
	12	11 237	20 234	33 231	49 226	71 218
	15	10 296	18 295	32 294	47 288	69 282
	20	8 395	14 395	29 393	44 390	64 381
25	4 498	10 496	25 494	40 490	59 484	

HMM Dimension and Mounting Data---Figuration

Factor: mm

Figuration A : Oil port on the bottom

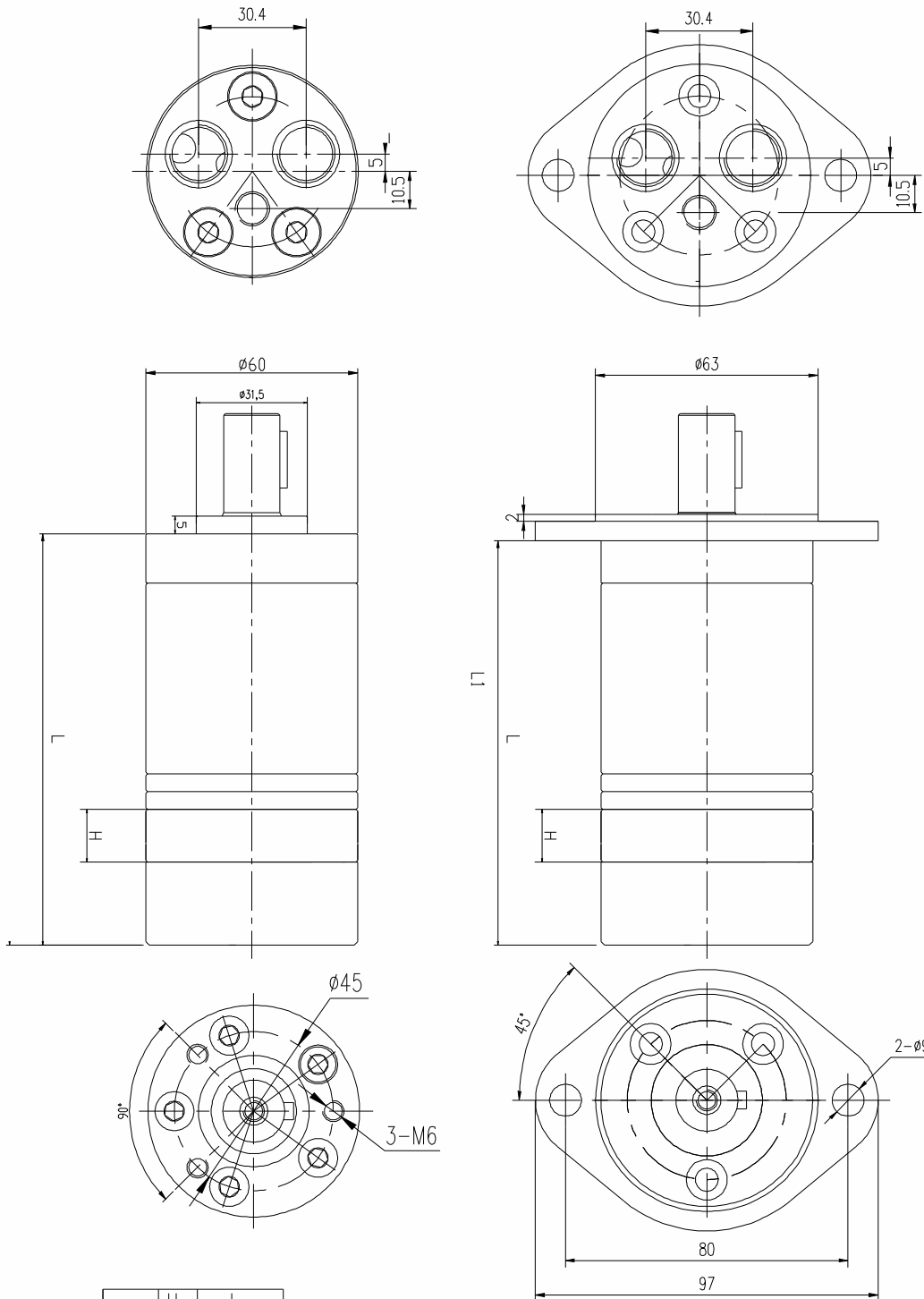

	H	L
8	5.8	107.8
12	9	111
20	14.5	116.5
32	23	121
40	29	131
50	37	139

HMM Dimension and Mounting Data---Figuration

Factor: mm

Figuration B : Oil port on the side

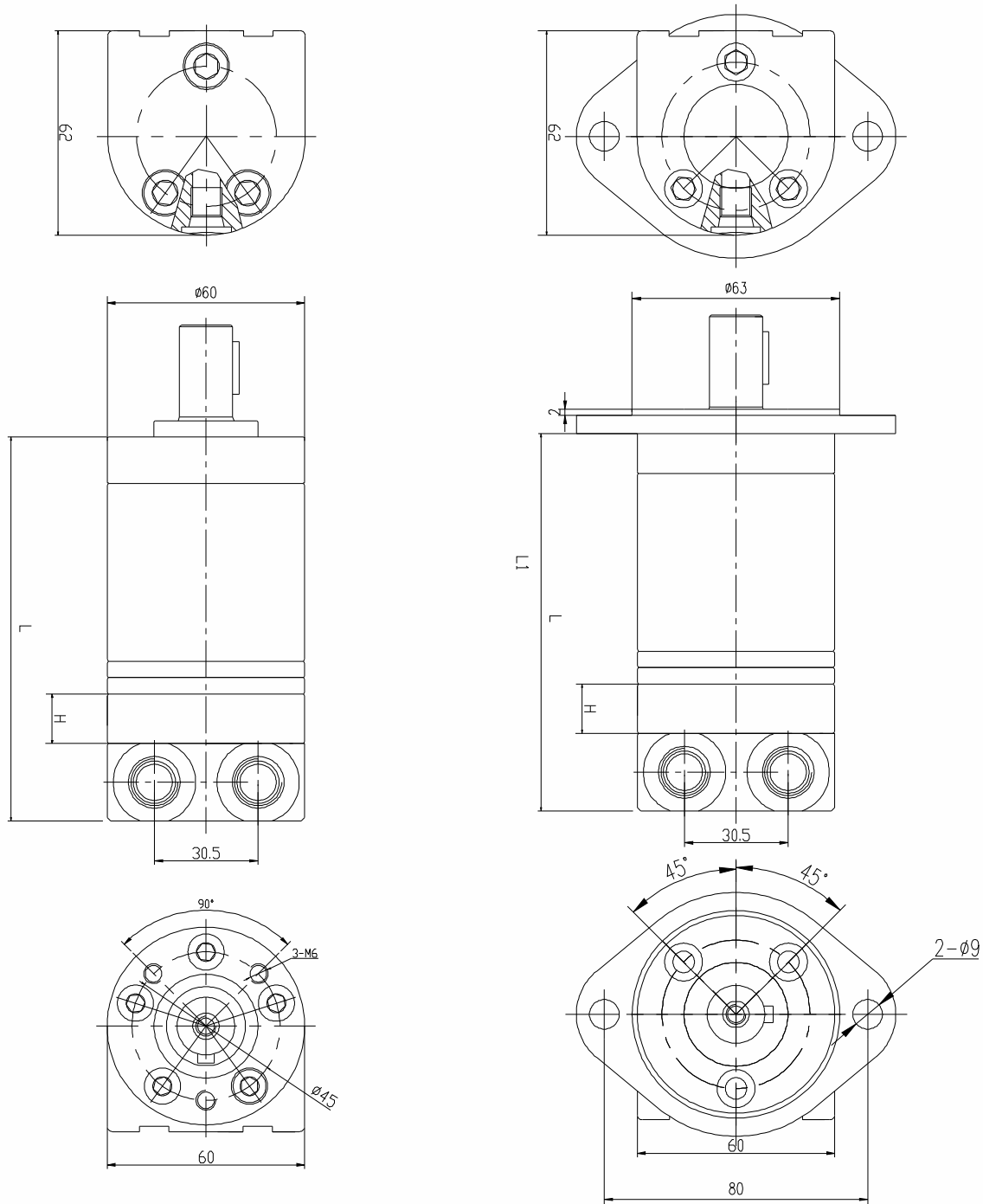

排量	H	L
8	5.8	107.8
12	9	111
20	14.5	116.5
32	23	121
40	29	131
50	37	139

HMM Dimension and Mounting Data---Mounting Flange

Factor: mm

Flange A

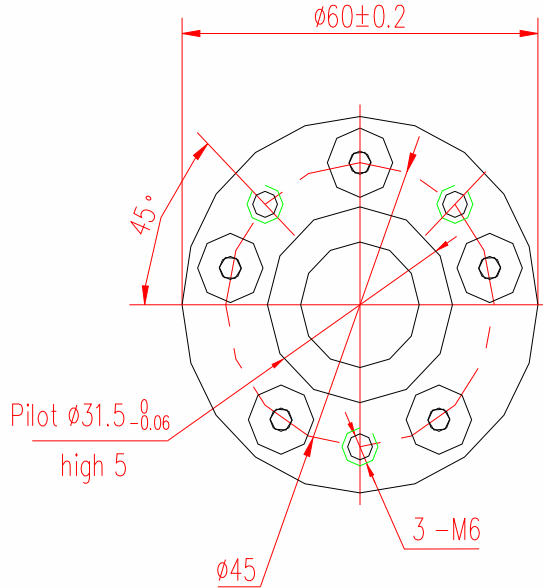

Flange B

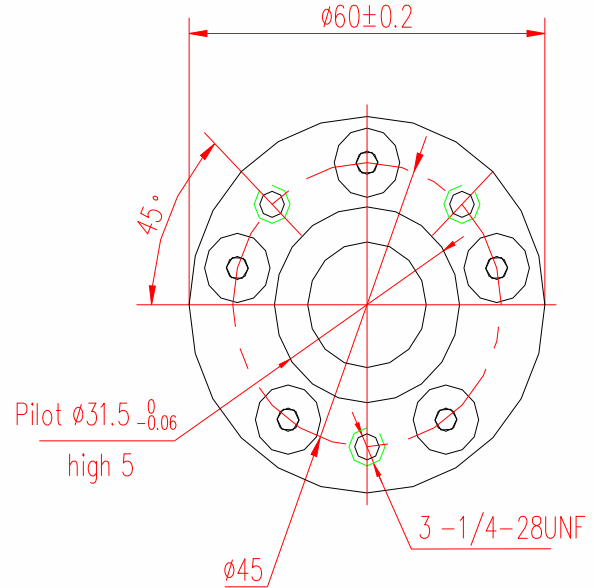

Flange C

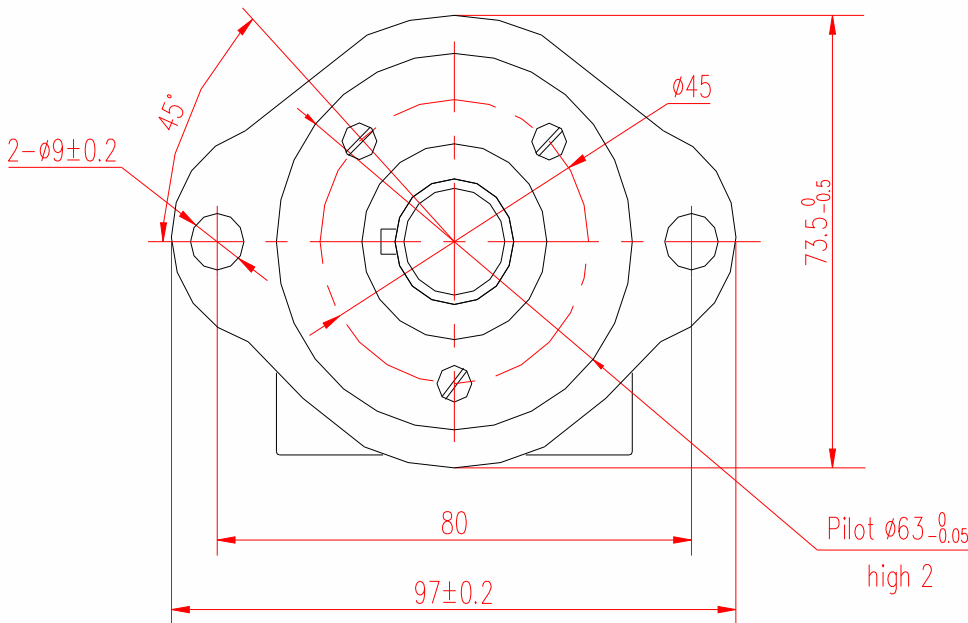

HMM Dimension and Mounting Data---Shaft

Factor: mm

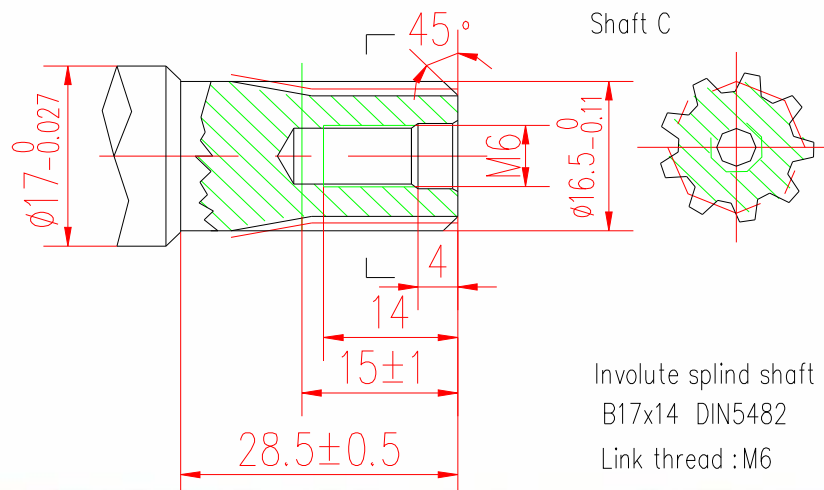
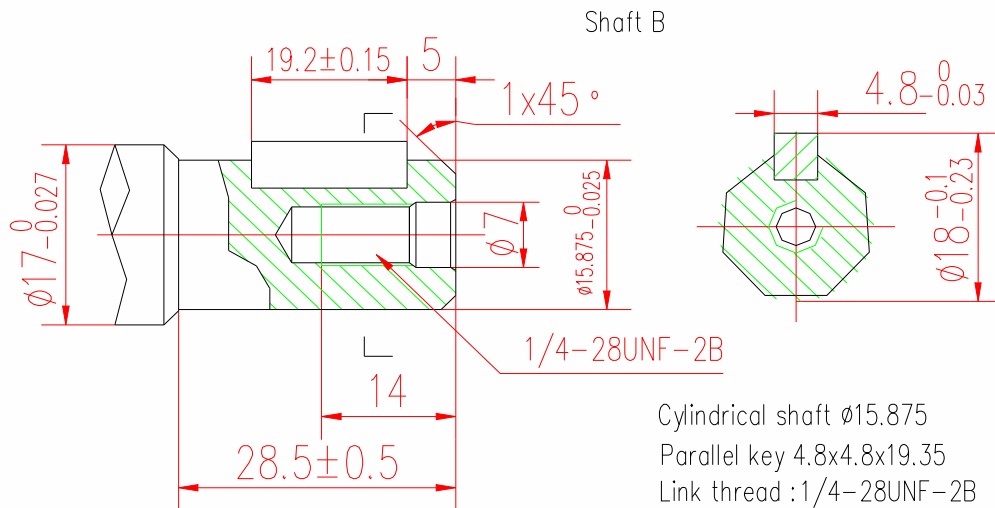
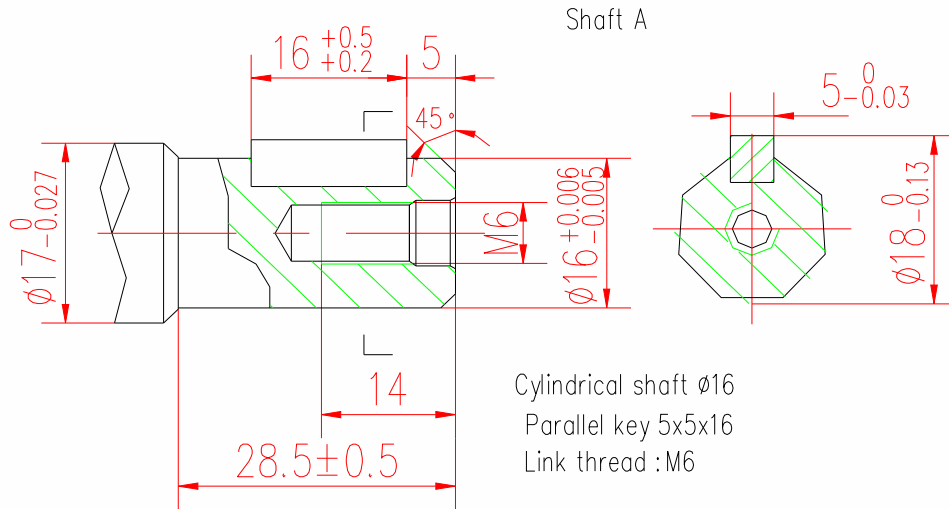

HMM Code number and Order information

If you have any other special demand about the figuration,dimension and mounting type,please contact us ,we can design specially.

HMM		1	2	3	4	5	6	7					
pos 1		2		3		4		5		6		7	
Figuration		Displacemet (ml/r)		Flange&Pilot (mm)		Shaft&key (mm)		Oil port		Drain port		Special	
A	oil port on the bottom	A	8	A	circle-flange, 3-M6 bolts distributing circle $\varnothing 45$, pilot $\varnothing 31.5 \times 5$	A	cylinder shaft; $\varnothing 16 \times 28.5$ parallel key: $5 \times 5 \times 16$ link thread :M6	A	2-G3/8	A	None	A	None
B	oil port on the side	B	12.5	B	circle-flange, 3-1/4-28UNF bolts distributing circle $\varnothing 45$, pilot $\varnothing 31.5 \times 5$	B	cylinder shaft: $\varnothing 15.875 \times 28.5$, parallel key: $4.8 \times 4.8 \times 19.35$, link thread :1/4-28UNF-2B	B	9/16-18UNF	B	G1/8	B	
		C	16	C	rhombus flange, 2- $\varnothing 9$ center space 80, pilot $\varnothing 63 \times 2$	C	Involute splind shaft: B17x14 DIN5482, Link thread :M6			C	3/8-24UNF	C	
		D	20										
		E	32										
		F	40										
		G	50										

Order example: HMMACAABBA